

Installation Instructions



Fig.1

1. Place the filter into the housing body as shown in fig.1.



Fig.2

2. Press the filter firmly in order to fit as shown in fig.2.



Fig.3

3. Place the gasket inside the cap as shown in fig.3.

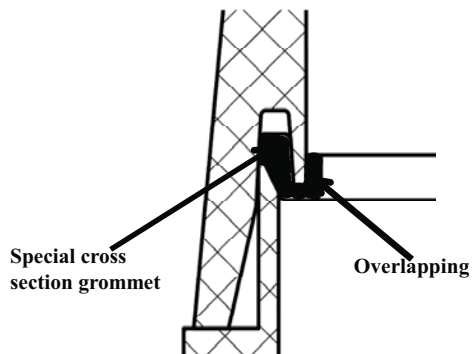

Fig.4

4. The cap with the gasket should look like fig.4



Fig.5

5. Place and tighten the cap on the housing as shown in fig.4.



Assembled