

## Mass Air Flow Sensor Schematic

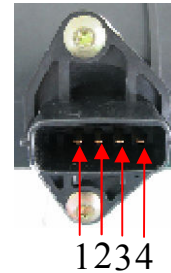

## Connection Diagram



- 1.+14V
2. ⊥ GND
- 3.Reference voltage:+5V
- 4.Air flow sensor output

## 1. DRAWING AND DIMENSION.(mm)

※General tolerance: coarse class

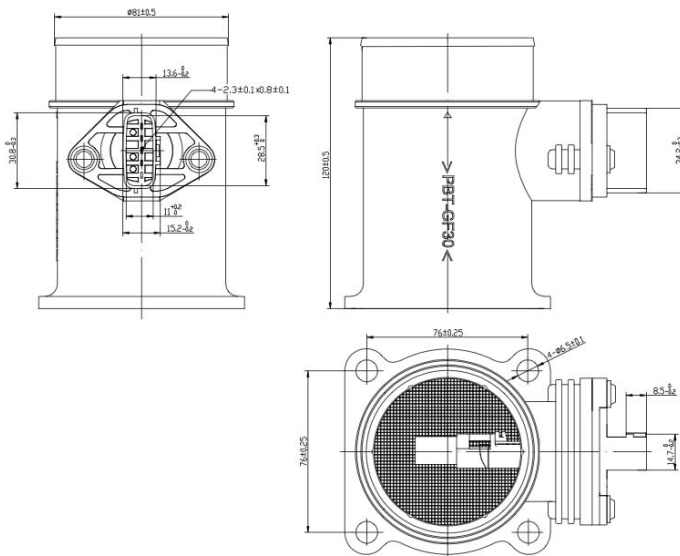

## 2. ELECTRICAL PROPERTIES

## 2.1 Operating Temperature Range :

(AT  $t=23\pm 5^{\circ}\text{C}$ )

Accuracy :  $\pm 7\%$

RT RESISTANCE : NO

Air-Flow Measuring Range : 10~480 Kg/h

## 2.2 OUTPUT VOLTAGE

(AT  $t=23\pm 5^{\circ}\text{C}$ )

INPUT VOLTAGE DC :  $14 \pm 0.1\text{ V}$

Output Voltage : 1~4.5 V

Response Time :  $\leq 100\text{ms}$

## Safety Characteristics:

◆Over voltage :  $V_s = 24\text{ V}$ , 60 sec, is turned ON/OFF without failure.

◆Repetitive Thermal Shock :

The MAF shall be designed to withstand 100 cycles of  $-40^{\circ}\text{C}$  to  $100^{\circ}\text{C}$  in 20 minutes and  $100^{\circ}\text{C}$  to  $-40^{\circ}\text{C}$  in 20 minutes.

◆Vibration Test :

The MAF is subjected to sinusoidal vibration in accordance with the following condition for a period of 15 minutes . Constant max. amplitude acceleration = 15G. Frequency = 10 to 500 Hz. Test time = 6 hours.

2013.9.25		1	陳海鵬	金馮海	許順威	MOBILETRON
Date of first edition	Date of revised edition	edition	Manuscript	Review	Approval	SEP.25.2013
						Release