



Das Original

Anziehvorschrift
Tightening Instruction
Instrucciones de serraje
Prescripciones de apriete
安装说明

477-340

Reihenfolge / Sequence / Commander / Sucesión / 安装顺序

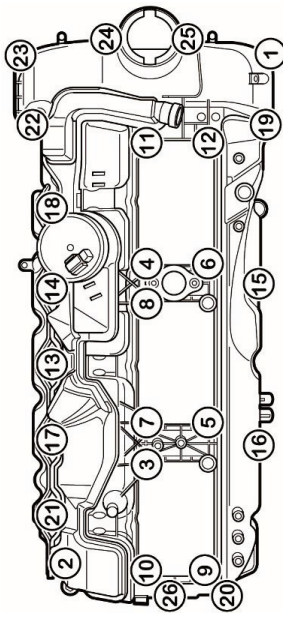

Step 标准步骤	Wert / Figure / Valeur / Tipo de motor / 发动机型号	metrisch/metric/métrico/ 毫米	US Standard
1.		Pos. 1-26: 180°	180°
2.		Pos. 1: 8,5 Nm	6.27 ft-lb
3.		Pos. 2: 8,5 Nm	6.27 ft-lb
4.		Pos. 3-26: 8,5 Nm	6.27 ft-lb

© Elring - Das Original 05/2020

Motortyp / Engine type / Type de moteur / Tipo de motor / 发动机型号

BMW
3.0 L / N55 B30 A
1'(E82), 3'(E90), 3'(F30), 4'(F32), 5'(F10), X1, X3, X4, X5, X6

ElringKlinger AG
Max-Eyth-Str. 2 | D-72581 Dettingen/Erms
Fon +49 7123 724-799 | Fax +49 7123 724-798
elring@elring.de | www.elring.com

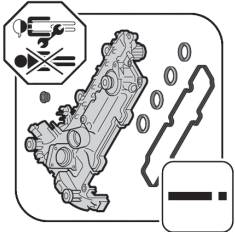

1.

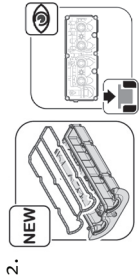

2.

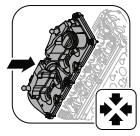

3.

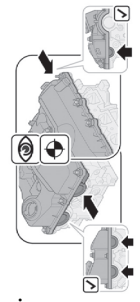

4.

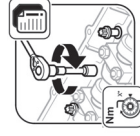

5.

© Elring - Das Original 05/2020 Vo003787

ElringKlinger AG

Max-Eyth-Str. 2 | D-72581 Dettingen/Erms
Fon +49 7123 724-799 | Fax +49 7123 724-798
elring@elring.de | www.elring.com



Das Original