

en High-pressure injection valve removal and installation instructions

de Hochdruckeinspritzventil Ausbau- und Einbauhinweise

cz Pokyny k montáži a demontáži vysokotlakého vstříkovačoho ventilu

el Υποδείξεις αφαίρεσης και τοποθέτησης της βαλβίδας έγχυσης υψηλής πίεσης

es Recomendaciones de montaje y desmontaje del inyector de alta presión

fi Korkeapaineruiskuventtiilin ohjeita asennukseen ja poistoon

fr Indications de démontage et de montage soupape d'injection à haute pression

hr Napomene za demontažu i montažu ventila visokotlačne mlaznice

hu Nagynyomású befecskendező szelep, ki- és beszerelési tudnivalók

it Raccomandazioni per il montaggio e lo smontaggio della valvola di iniezione ad alta pressione

ja 高圧インジェクションバルブの取り外し・取り付け説明書

nl Uit- en inbouw instructies hogedrukinjectieklep

pl Wskazówki dotyczące demontażu i montażu zaworów wtryskiwaczy wysokociśnieniowych.

pt Instruções de instalação e desinstalação do injetor de alta pressão

ro Instrucțiuni pentru demontarea și montarea injectorului de înaltă presiune

ru Указания по демонтажу и установке форсунки высокого давления

tr Yüksek basınçlı enjeksiyon valfi çıkartma ve takma talimatları

zh 高压喷射阀拆卸和安装提示



EAC 1 987 261 008



BOSCH

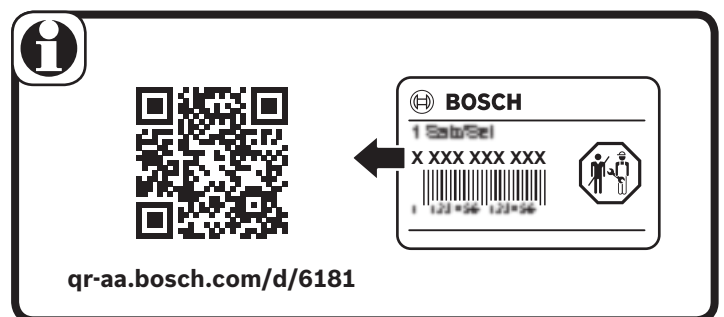
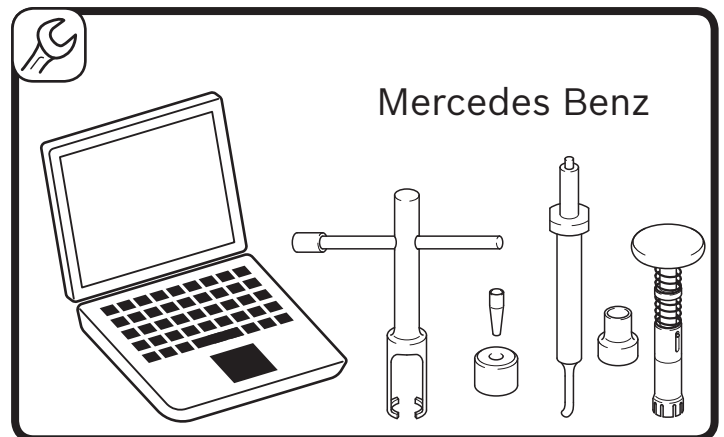
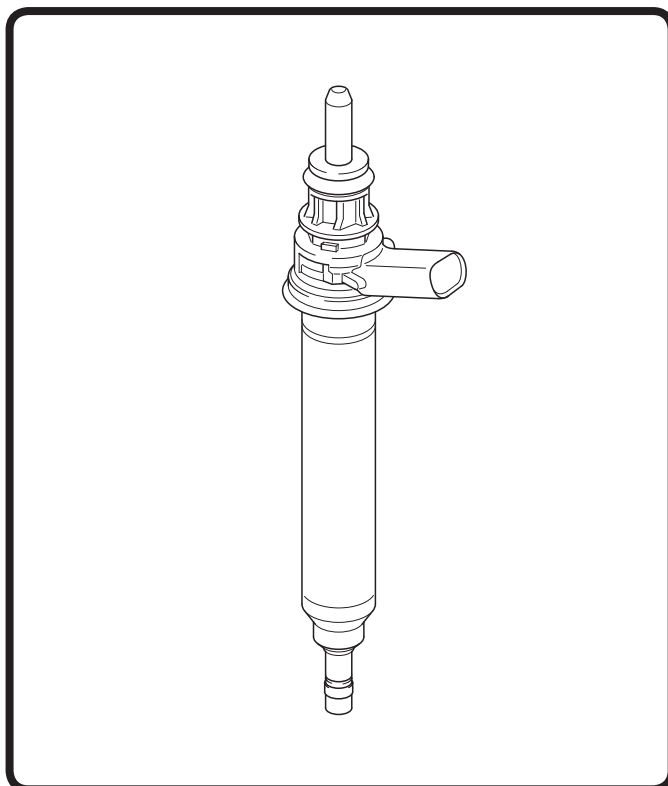

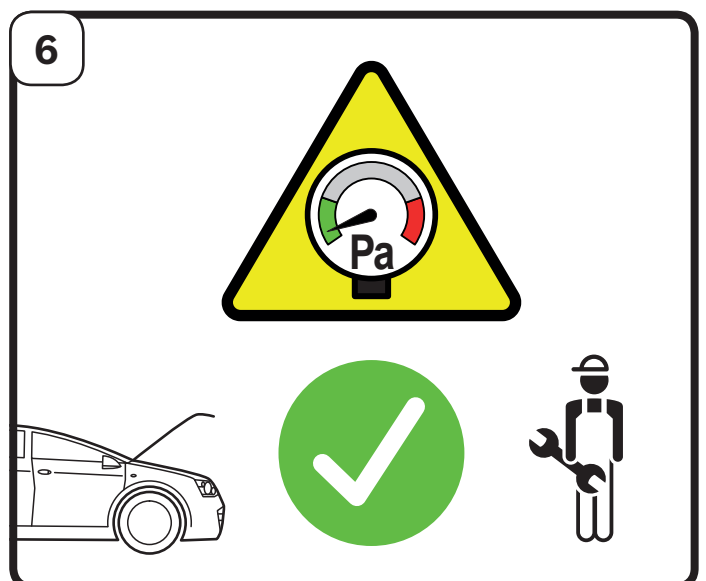
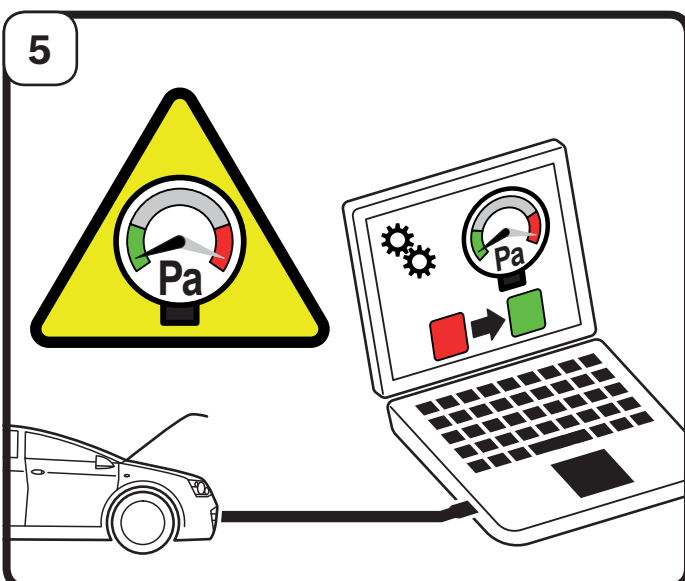
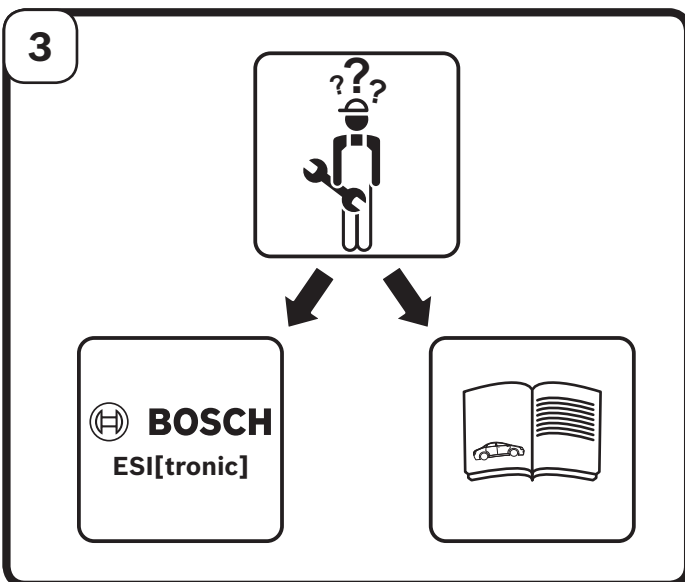
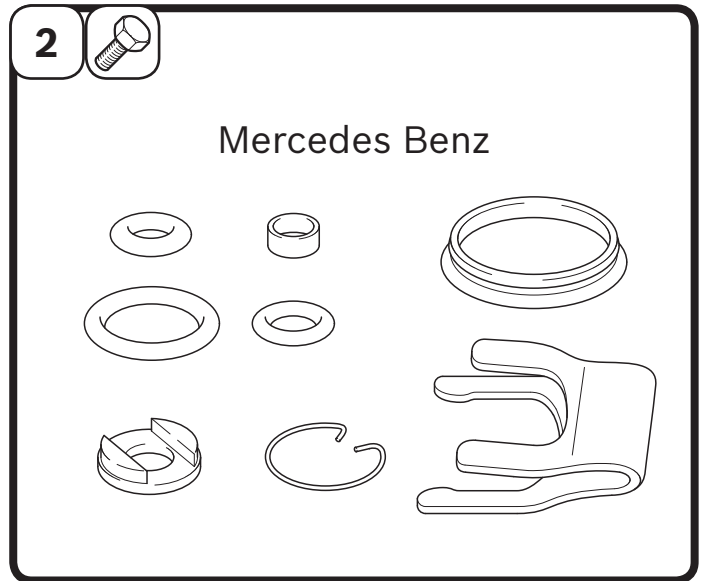
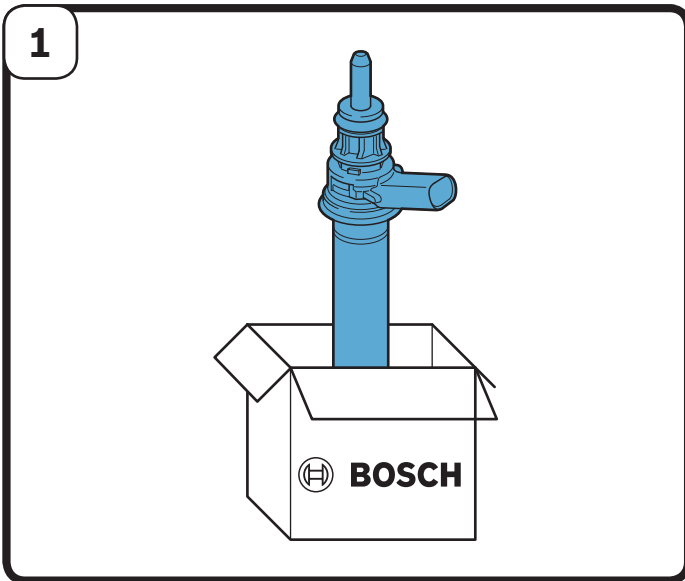

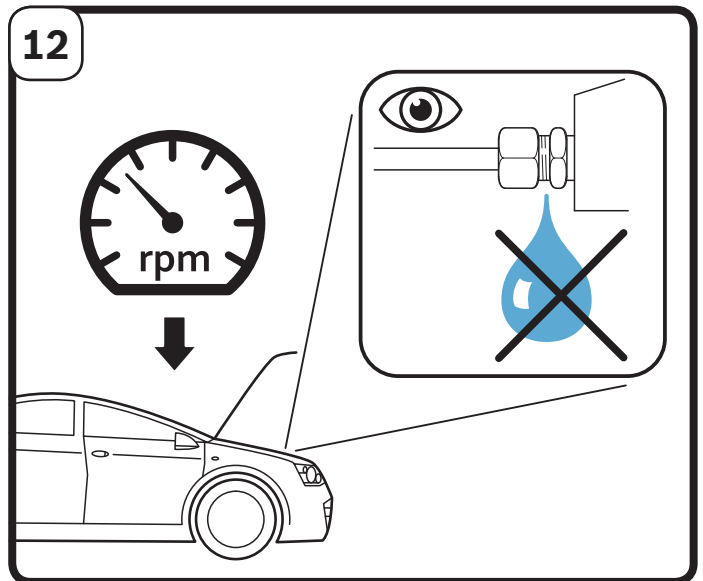
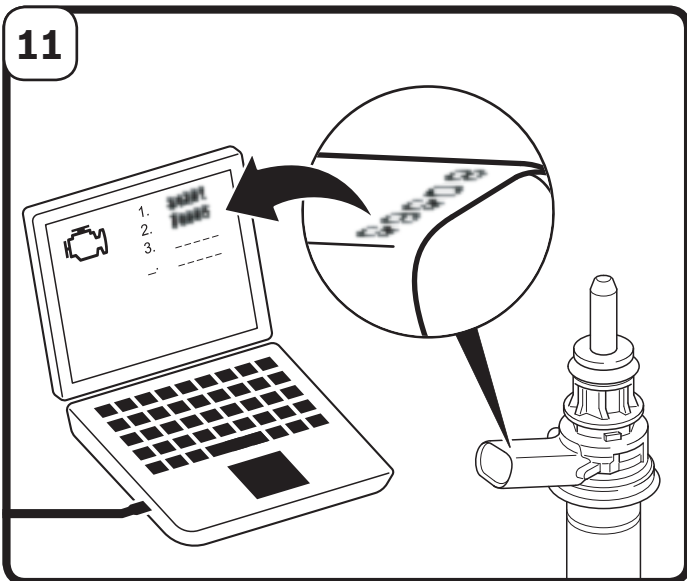
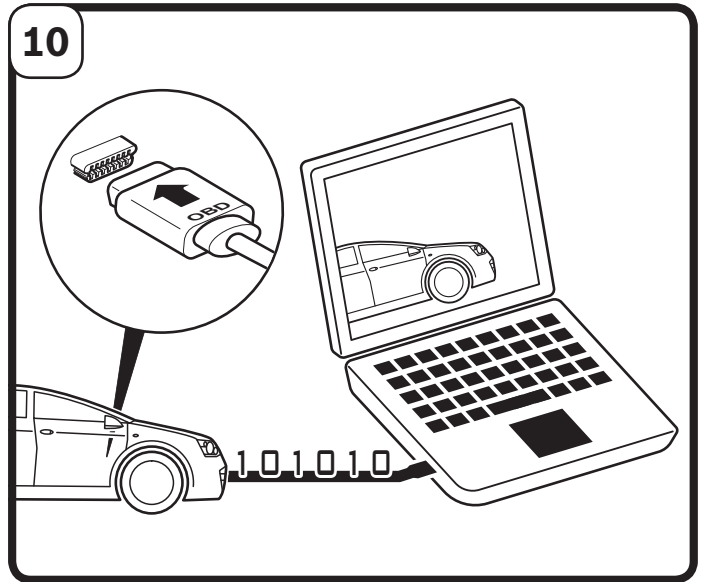
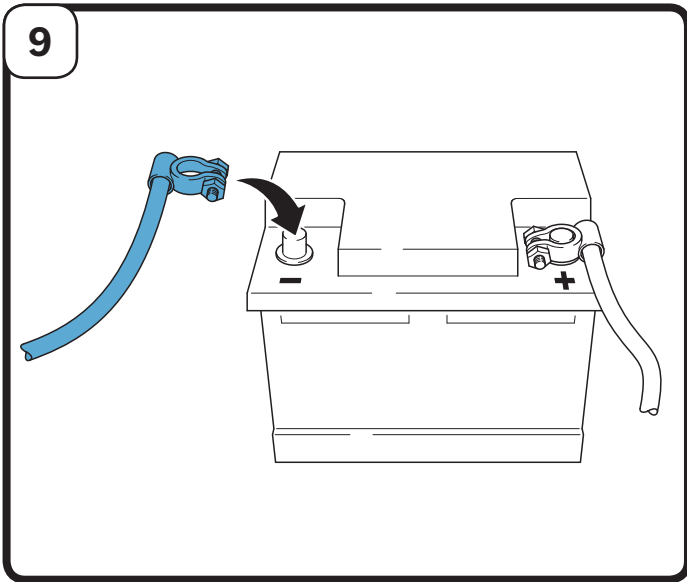
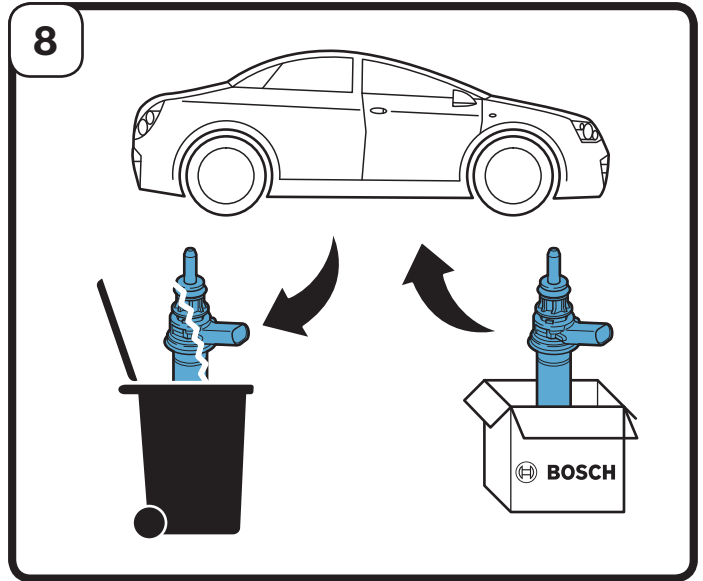
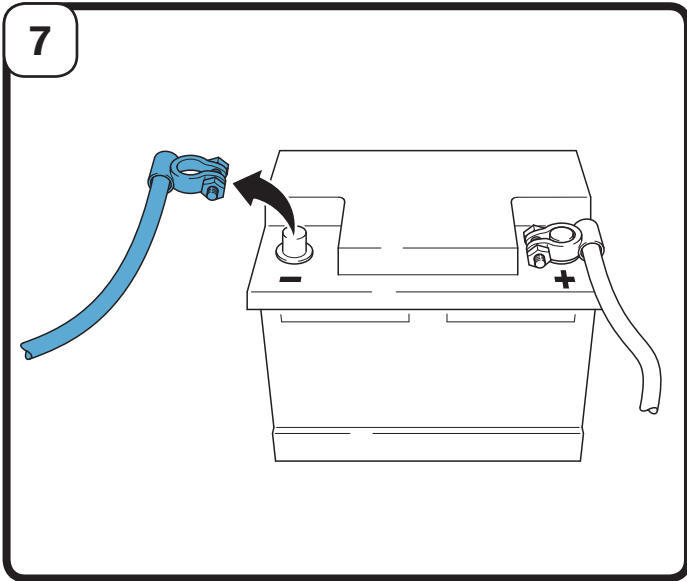

13

